

Performance

with an

Experience



Hydraulic Elevators

• **Since 1996** •



Type of Suspension

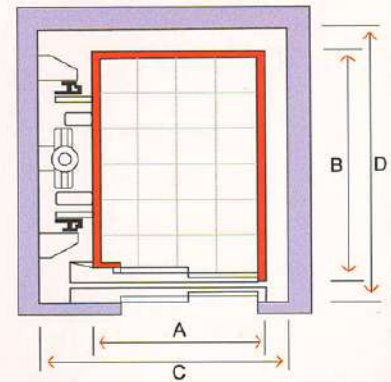
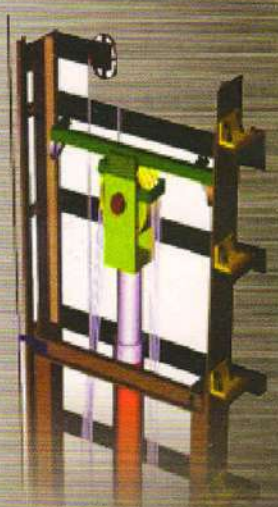

ROPE TYPE 1

It is a single side indirectly acting suspension with wire ropes having one piston for regular loads and long travels of maximum 12 meters.

Persons	Capacity kg	Car-w (A)	Card-d (B)	Shaft-w (C)	Shaft-d (D)
3	225	800	900	1300	1300
4	300	850	1050	1350	1450
5	375	1000	1200	1500	1500
6	450	1100	1250	1600	1600
8	600	1200	1500	1750	1800
10	750	1200	1700	1750	2200
12	900	1300	1800	1850	2100
15	1125	1300	2200	1850	2500
20	1600	1400	2500	1950	2800

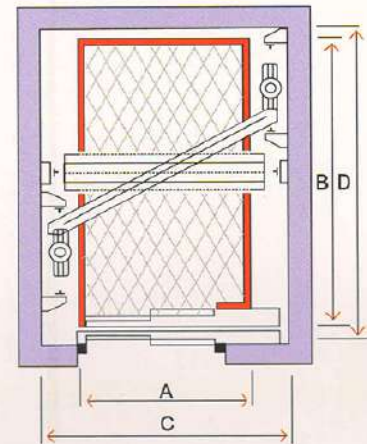

ROPE TYPE 1

It is an indirect suspension with wire ropes having dual pistons for heavy loads and long travels of maximum 12 meters.

Persons	Capacity kg	Car-w (A)	Card-d (B)	Shaft-w (C)	Shaft-d (D)
10	750	1200	1700	1900	2000
12	900	1300	1800	2000	2100
15	1125	1300	2200	2000	2500
18	1350	1350	2350	2050	2700
20	1500	1400	2500	2100	2900
26	2000	1600	2600	2300	3000
30	2300	1700	2700	2400	3100
33	2500	1700	2800	2500	3200

Type of Suspension

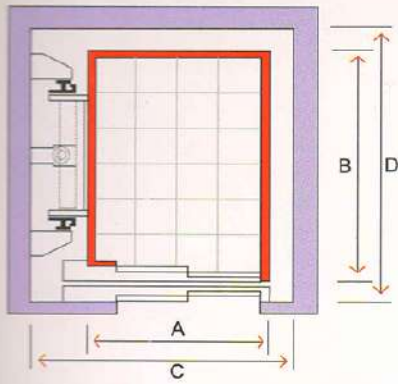

HOLELESS TYPE 1

It is a single side direct suspension with a single simple piston for regular loads for short travels of maximum 4 meters.

Persons	Capacity kg	Car-w (A)	Card-d (B)	Shaft-w (C)	Shaft-d (D)
3	225	800	900	1300	1300
4	300	850	1050	1350	1450
5	375	1000	1200	1500	1500
6	450	1100	1250	1600	1600
8	600	1200	1500	1750	1800
10	750	1200	1700	1750	1950
12	900	1300	1800	1850	2100
15	1125	1300	2200	1850	2500
20	1500	1400	2500	1950	2800

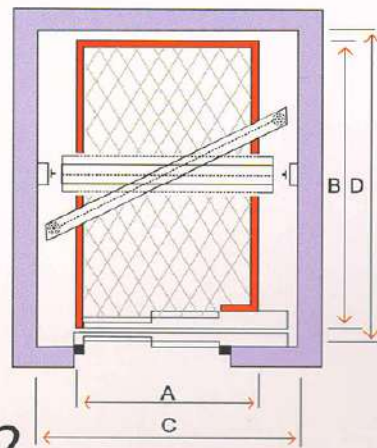

HOLELESS TYPE 2

It is a double side direct suspension with dual simple pistons for heavy loads and short travels of maximum 4 meters.

Persons	Capacity kg	Car-w (A)	Card-d (B)	Shaft-w (C)	Shaft-d (D)
10	750	1200	1700	1900	2000
12	900	1300	1800	2000	2100
15	1125	1300	2200	2000	2500
18	1350	1350	2350	2050	2700
20	1500	1400	2500	2100	2900
26	2000	1600	2600	2300	3000
33	2500	1700	2800	2500	3200
40	3000	1900	3000	2700	3400



Type of Suspension

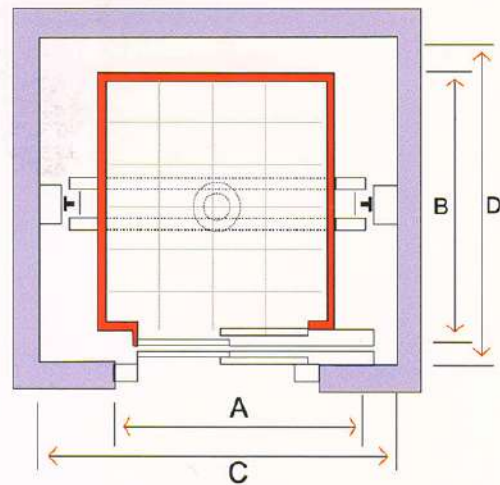
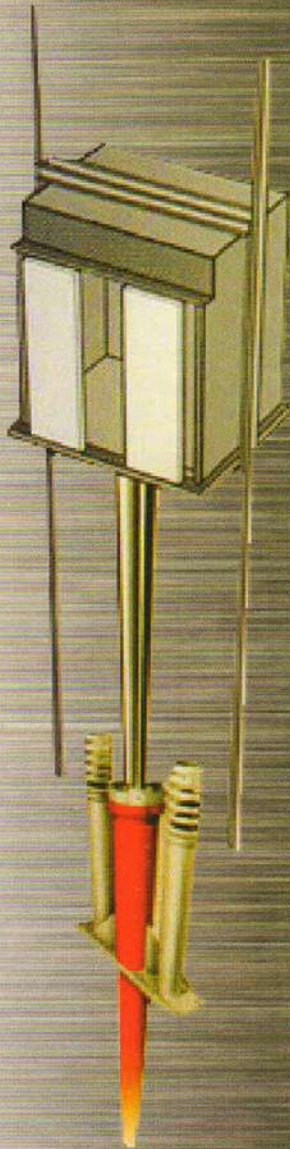

HOLE TYPE

It is a directly suspension with a simple or split piston. It s the simplest solution of suspension for any load. up 6 meters travel..

Persons	Capacity kg	Car-w (A)	Card-d (B)	Shaft-w (C)	Shaft-d (D)
3	225	800	1500	1500	
4	300	850	1050	1550	1550
5	375	1000	1200	1600	1600
6	450	1100	1250	1700	1700
8	600	1200	1500	1700	1800
10	750	1200	1700	1700	2000
12	900	1300	1800	1900	2100
15	1125	1300	2200	2000	2500
20	1500	1400	2500	2100	2800
24	1800	1500	2500	2200	2800

Car Parking Lift

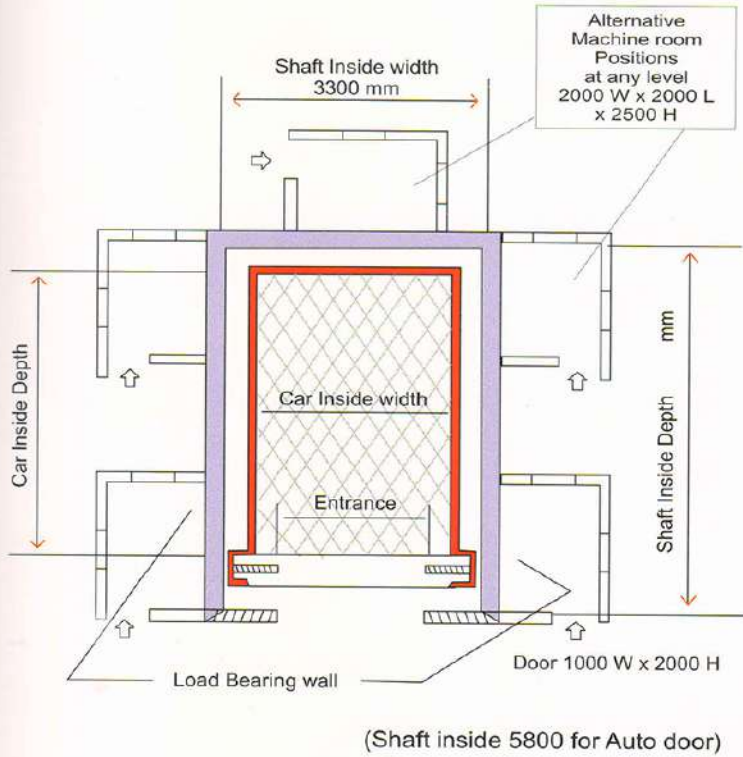

These lifts are specially designed for the vertical transportation of a loaded vehicle or automobile with their drives making them extremely useful for Private Garages, Apartments, Showrooms, Service Stations and Complexes.

These lifts meet the requirements of the current INDIAN LIFT GUIDELINES.

Shaft Inside	W 3300	D 5500	Machine Room	2000W x 2000L x 2500H							
Recommended Shaft Dimensions for 2.5 Tones Hydraulic Car Lift-Non Commercial vehicle											
Type of lift	Capacity (Kg)	Car + Car FR. + ACC. Weight (Kg)	Total Load (Max) (Kg)	Car Inside Dimension (mm)			Entrance (mm)		Travel (max) (mm)	Pitdepth (min) (mm)	O.H. Height (min) (mm)
				W	D	H	W	H			
Direct pistons at side (2 Nos.)									4000	1800	4000
Indirect pistons at side (2 Nos.)	2500	2500	5000	2400	5200	2300	2300	2200	12000	1500	3500
Direct pistons below (2 Nos.)									6200	1500	3500



Components

BLAIN

POWER UNIT

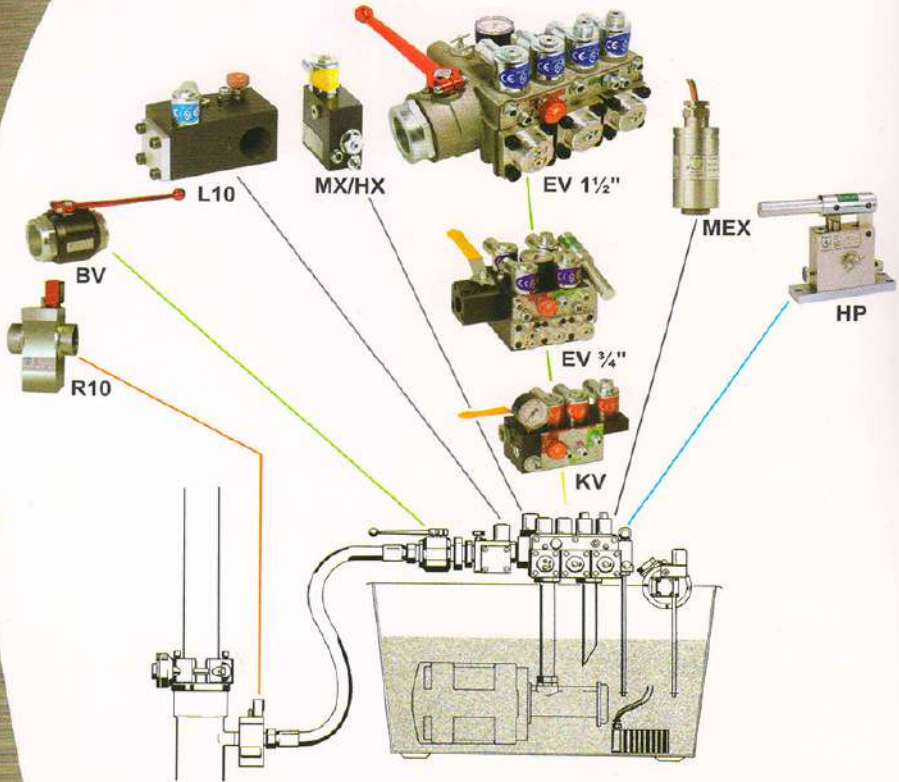
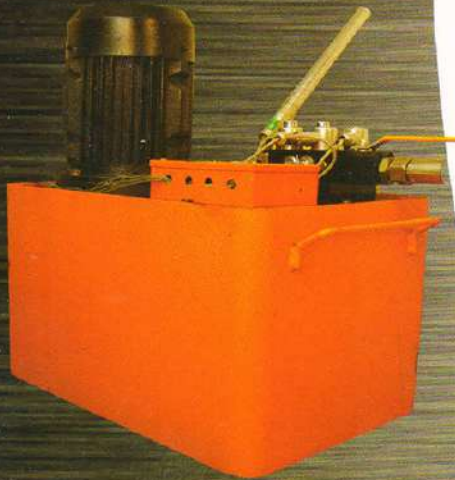

CAR FRAME



CYLINDER PULLY

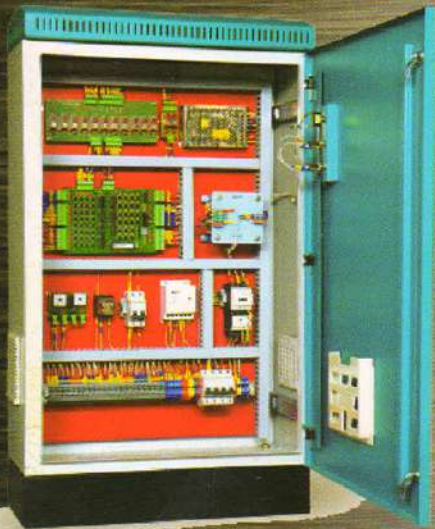
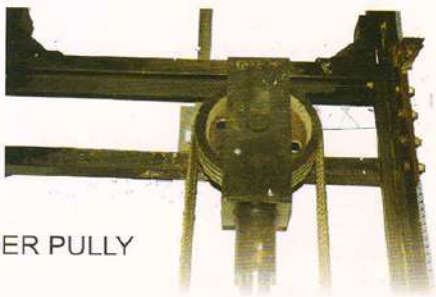

CONTROL PANEL



Safer To Rescure

COMPARISON

Hydraulic Elevators to Machine Room less Traction Elevators (MRL)

STALLED ELEVATOR

In an Apartment, Office, Clinic, Store or other low rise building, it may be necessary to quickly release persons from a stalled elevator.

MRL TRACTION ELEVATORS

The procedures to release passengers from a stalled MRL Traction Elevators can be complicated, time consuming and physically demanding.

A mechanic or fireman requires considerable knowledge and practice, to perform a safe and efficient operation on the many different types of MRL elevators with which he may be confronted in an emergency.

Establishing where the machine drive equipment is, may itself cause some delay. How to gain access can add to time lost and finally how to safely operate the brake release and shift the car either upwards or downwards to a secure landing position is and exercise for specialists. In some cases it may take hours before the qualified mechanic is even contacted and on the scene.

HYDRAULIC ELEVATORS

With hydraulic elevators, a safe machine room can almost always be convergently positioned close to the elevator shaft in the basement or first floor of the building. Opening the manual lowering knob or level is basically the same with all types of elevator control valves and is a simple matter, even for a responsible apartment caretaker, clinic nurse or informed family member in the case of a home lift, taking perhaps one minute to cautiously lower the car to floor level. Through the optional inclusion of a low cost hand pump, the car can also be raised to a higher floor should it be required **Note : In the instance of manual lowering, first of all check that all doors (landing as well as car doors) are closed.**

EXPOSURE TO DANGER

During the installation and servicing of an MRL elevators, the mechanic is obliged to perform more of his work in or alongside the open shaft. This obviously entails additional risks.

COMPARATIVE OPERATING COSTS

It is claimed that the traction MRL elevator is more energy efficient and therefore cheaper to operate than the hydraulic elevator.

OBLIGATION TO INFORM

The architect as well as the final owner or user of the elevators, should be correctly and thoroughly informed of the alternative rescuing systems of both the MRL traction elevator and the hydraulic elevators.

Electric Elevator (Passenger trapped)



Electric Drive

Fire !
Difficult or impossible access to electric drive & lowering device due to heat, smoke & elevation

Earthquake Rescue operation made precarious by damage to upper floor machinery & counterweight structure

Hydraulic Elevator (Passenger freed)

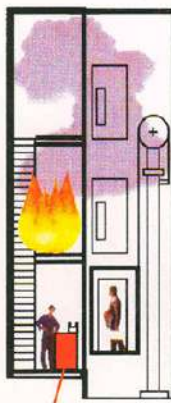

Hydraulic Drive

Fire !
Easy access to hydraulic drive and emergency lowering valve at ground floor level

Earthquake Little or no damage to hydraulic drive. No counterweight to create extra danger





For **Low Rise**

applications in

Bungalows

Hospitals

Offices

Industries

Showrooms

Car Parking



Newmec

New Manu
Engineering & Co.



Mfrs. of All Types of
Hydraulic Elevators

Plot No. 71/1, G.I.D.C., Phase-1, Above Punjab National Bank,
Vatva, Ahmedabad-382445. (Gujarat) INDIA Phone : +91 - 79 - 25835036
Mobile : +91 - 98258 08861 / +91 - 94275 08185

E-mail.: newmanueng@yahoo.co.in ■ newmcelevators@gmail.com

Web Site
www.newmanueng.com